

G4
SERIES
SERIES
G4

L3220G4 MULTIAPPLIER



Dual hopper application of fertilizer:

- Broadcast two products simultaneously.
- Control conveyors independently.
- Broadcast fertilizer from 60' to 84'.

Single hopper conversion:

- Broadcast ag lime.
- Broadcast pre-blended fertilizer.
- Broadcast fertilizer from 60' to 105' and lime up to 60'.

Building the best since 1939.



New Leader has incorporated the accuracy and quality of the L3020G4 fertilizer and lime spreader into a new spreader that permits dual or single product application. Introducing. . . .

The new L3220G4 spreader with the MultApplier dual hopper insert!

The patent-pending MultApplier broadcasts two materials simultaneously for spreading materials independently or together at a predetermined rate.

After removing the MultApplier dual hopper insert, the L3220G4 works alone to broadcast a single application of lime or fertilizer. It achieves the same accurate spread pattern as the well-known L3020G4, with effective swath widths from 60' to 105' when spreading fertilizer and up to 60' when spreading lime.

After more than 60 years of building the best spreaders in the industry, New Leader is proud to offer this innovative product that upholds our tradition of quality. Diversify your services and multiply your profits with the New Leader L3220G4 spreader and MultApplier dual hopper insert!

MultApplier Removed



Installation of L3220G4 Endgate



L3220G4 Single Hopper Features & Benefits

- Removal of the MultiApplier dual hopper insert converts the unit to spread a single application of lime with effective swath widths up to 60' or fertilizer with effective swath widths from 60' to 105'.
- The extra wide 30" belt-over-chain conveyor reduces material bridging when spreading lime, and provides uninterrupted delivery when spreading fertilizer.
- The swinging inverted "V" reduces conveyor load and prevents material bridging when spreading lime.
- The dished spinner design includes predetermined settings for fertilizer, urea, lime, and wet lime to simplify spread pattern testing and daily application.
- Achieve a range of application rates from 75 pounds of fertilizer per acre to over six tons of lime per acre.



- The simple, under two-hour conversion to remove the MultiApplier and install the L3220G4 endgate increases diversity and profitability. (Overhead lift required.)

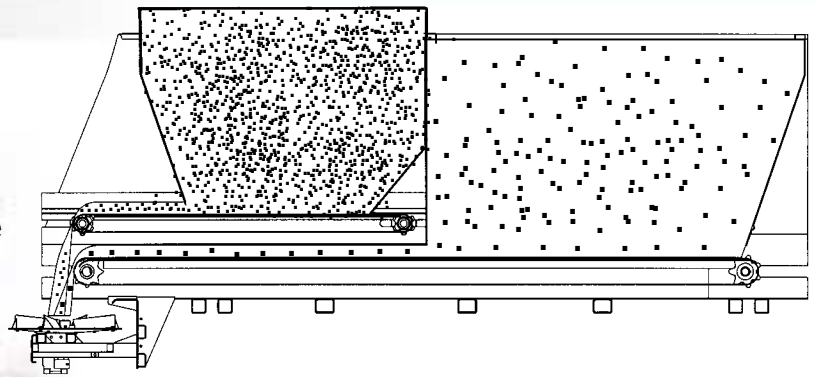

L3220G4/MultiApplier Dual Hopper Features & Benefits

- The dual hopper spreader permits simultaneous application of two products at a predetermined rate. Broadcast fertilizer from 75 lbs. per acre to 1100 lbs. per acre at 15 miles an hour. Achieve effective spread widths from 60' to 84'.
- The MultiApplier features a 24" wide belt-over-chain conveyor to provide the uninterrupted delivery needed when spreading fertilizer.
- The hi/low gate settings are fixed at 3" or 1 1/2" for simplified set up and operation.
- The 5' long MultiApplier is constructed of heavy-duty 304 unpainted stainless steel to resist corrosion. The L3220G4 is available in lengths of 12', 13' and 14' with construction in your choice of carbon steel, 409 painted stainless steel, or 304 unpainted stainless steel.

Specifications



Building the best since 1939.

L3220G4

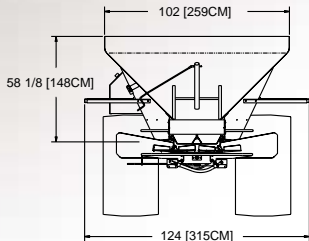

DIMENSIONS AND CAPACITIES (102" WIDTH HOPPER)

Body Length	Overall A	Inside B	Frame C	Cab to Axle-C.T.	Struck Capacities	
					Cubic Yds. (Cu. Ft.)	cu. m.
12 ft. 3.66m	172" 436.9cm	144" 365.8cm	135" 342.9cm	*102" 259.1cm	9.43 (255)	7.21
13 ft. 3.96m	184" 467.4cm	156" 396.2cm	147" 373.4cm	**102-108" 259.8-274.3cm	10.26 (277)	7.84
14 ft. 4.27m	196" 497.8cm	168" 426.7cm	159" 403.9cm	**120" 304.8cm	11.10 (300)	8.48

L3220G4 / MultiApplier

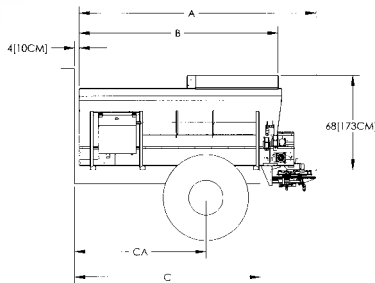

WEIGHTS AND CAPACITIES (102" WIDTH HOPPER/MULTAPPLIER)

Body Length	L3220G4 Spreader Weight	MultiApplier Weight	Struck Capacities	
			L3220G4 Less MultiApplier	MultiApplier (only)
			Cubic Yds. (Cu. Ft.)	cu. m.
12 ft. 3.66m	3430 lbs 1556 kg	1000 lbs 454 kg	5.51 (149)	4.21
13 ft. 3.96m	3680 lbs 1670 kg	1000 lbs 454 kg	6.34 (171)	4.85
14 ft. 4.27m	3930 lbs 1783 kg	1000 lbs 454 kg	7.18 (194)	5.49

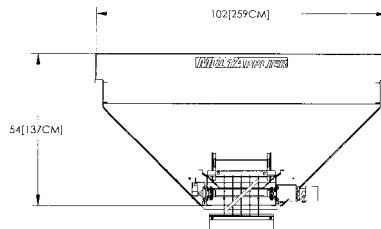
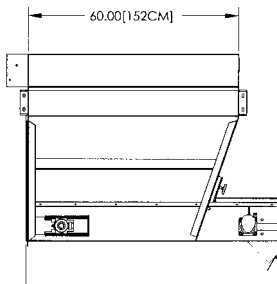

FENDERS AVAILABLE IN OVERALL WIDTHS OF 124" & 132".

Cab To Axle (CA) Measurement: Please consult federal, state, and local weight laws and chassis manufacturer's ratings to ensure neither government weight restrictions nor the GVWR and GAWRs are exceeded. Tire and tandem axle size may require mounting modification of optional mud flaps.

Contact Highway Equipment Company or your local New Leader dealer for more information.

Highway Equipment Company

1330 76th Ave. SW

Cedar Rapids, IA 52404-7052

Phone: 319/363-8281 or 800/363-1771

Fax: 319/632-3081 or 800/363-8267

Info@HighwayEquipment.com

www.HighwayEquipment.com

Contact factory for control compatibility.

Products and specifications subject to change without notice.

Photos and illustrations may or may not include optional equipment.

L3220G4 and MultiApplier are trademarks of Highway Equipment Company.

© 2002 Highway Equipment Company, Inc.

Form No. NL016